

INDEX

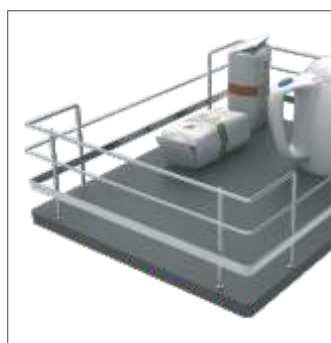

2-12	Elnora Accessories
13-22	Base Cabinets Accessories
23-24	Wall Units Accessories
26-26	Midway Accessories
28-30	Kessebohmer - Lift-up Fittings
31-34	Grass - Drawer System
35-36	Tecnoinox
37	Crown - Drawer Insert
38-41	Hardware & Fittings
42	Handles

ABOUT US

Sleek Kitchens

It would be true to say that Sleek has changed the way Indians cook today. The first to introduce the concept of modular kitchen in India, Sleek has consistently innovated and refined its products to offer the best to the Indian consumer.

The company started its manufacturing process with plastic coated wire accessories, and soon added Stainless Steel accessories to its product portfolio under the brand name Sleek Designer & Sleek Tuff basket. The company then diversified into kitchen cabinets, shutters, hardware, appliances. Today, Sleek stands tall as a complete kitchen solutions provider.

In 2013, Sleek aligned forces with Asia's largest paint company - Asian Paints Pvt. Ltd.. With this association, Sleek is looking forward to unprecedented growth in the coming years. Today, Sleek boasts of the largest network of kitchen dealers based all over India.

The company lays special emphasis on training its kitchen designers. The professional training program aims at equipping them with all the knowledge and skills required to make them a Specialist in this field.

Sleek's state-of-the-art manufacturing units at Vasai and Pune are the backbone of the company. The brand new Application Centre at Mumbai houses all the latest innovations designed by Sleek's specialist designers.

The company has also tied-up with many International giants including Grass, Tecnoinox, Scilm, Kessebohmer to offer world-class quality and workmanship to the discerning Indian consumer. With orders pouring in from the Gulf and African countries, Sleek is now making inroads into the global market as well.

Awarded

- Winner of Trusted Brand in Gold Category voted by Readers Digest 2015.
 - Fastest Growing Brand (Modular Kitchen) 2013.
- Kitchen Professional of the year at India Kitchen Congress 2013.
 - One of the 50 Most Talented Retail Professionals of India by ET NOW - Award for Excellence at Asia Retail Congress.
 - Most Preferred Kitchen Brand of the Year 2012.
 - Kitchen Retailer of the Year 2012.



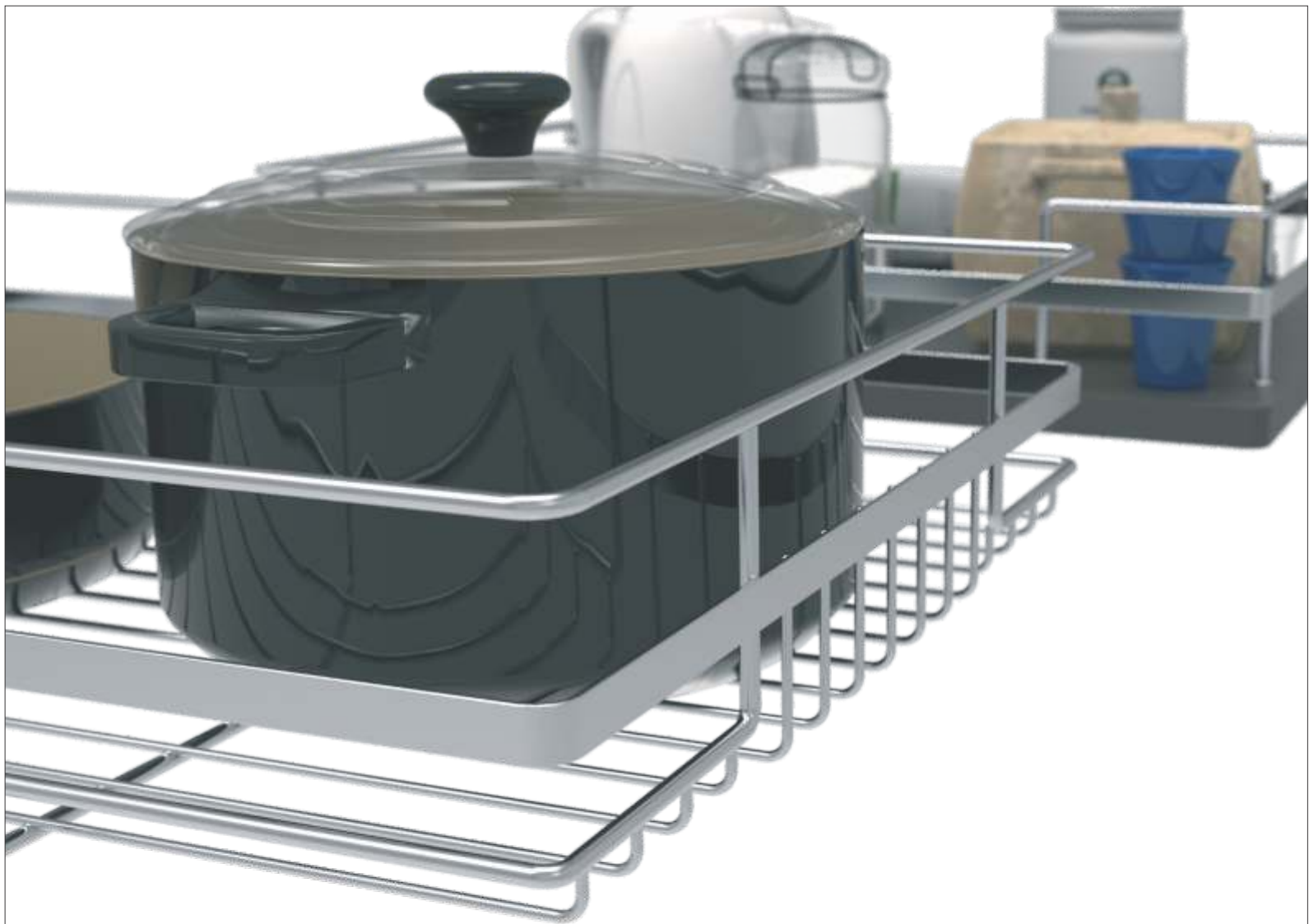

- **Solid bottom for Solid support**
- **Elegant Chrome Finish**
- **10-Year* Warranty**
- **Need Specific Design**
- **Ergonomically Crafted**
- **Unique Design**

Functionality with the
touch of Exquisiteness is
something that defines

Enora

Perfect Storage Solution

Just have a glance over the transformations which Sleek has done to thousands of kitchens in the country, and you'll get a fair idea why no one knows the Indian kitchen better than Sleek. Over the years with its worldwide recognized quality, Sleek has always exceeded expectations with its long list of innovations woven around functionality, aesthetics and consumer insight.

The perfect testimony to the above statement can be very well experienced with its launch of ELNORA, an eclectic range of baskets. With the definition of clever, stylish and smart storage, the ELNORA baskets are destined to put a full stop to the storage dilemma in your kitchen.

So just give your kitchen the touch of ELNORA and experience the kitchen organisation like never before.

SS ELNORA PLAIN BASKET

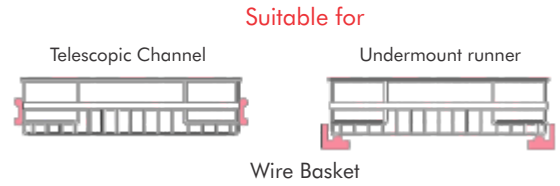

CODE NO.	DIMENSION (mm)	CABINET SIZE (mm)
	W X D x H	W X D x H
ASSEPL380505100 / 150 / 200	380 x 505 x 100 / 150 / 200	450 x 560 x 700 / 720
ASSEPL380405100 / 200	380 x 405 x 100 / 200	450 x 560 x 700 / 720
ASSEPL430505100 / 150 / 200	430 x 505 x 100 / 150 / 200	500 x 560 x 700 / 720
ASSEPL430405100 / 200	430 x 405 x 100 / 200	500 x 560 x 700 / 720
ASSEPL530505100 / 150 / 200	530 x 505 x 100 / 150 / 200	600 x 560 x 700 / 720
ASSEPL530405100 / 200	530 x 405 x 100 / 200	600 x 560 x 700 / 720

Can be installed on Telescopic channel



Can be installed on Undermount runner for Wire basket

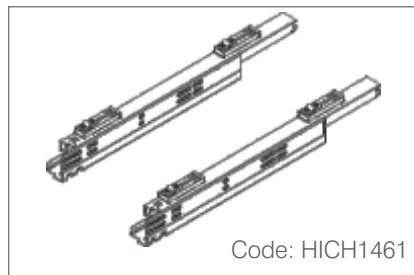

Undermount runner available only for 505mm basket

NOVA pro clips for Elnora basket



* Order Nova Pro Clip + Nova runner if you want to install basket on Nova runner

Available Heights



100mm/4"



150mm/6"



200mm/8"

SS ELNORA FLAT BASKET

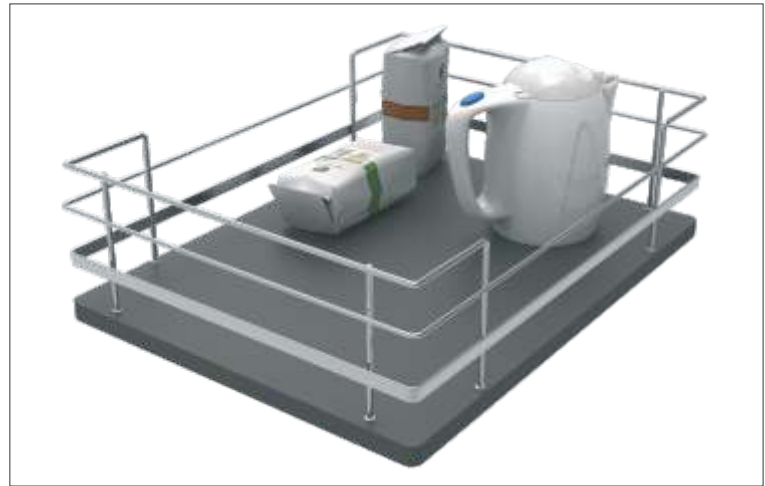
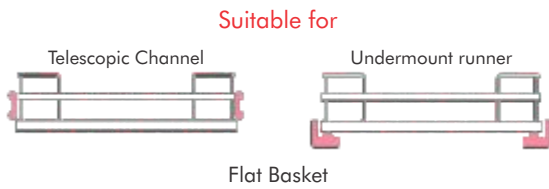

CODE NO.	DIMENSION (mm)	CABINET SIZE (mm)
	W X D x H	W X D x H
ASSEFPL380505100 / 150 / 200	380 x 505 x 100 / 150 / 200	450 x 560 x 700 / 720
ASSEFPL430505100 / 150 / 200	430 x 505 x 100 / 150 / 200	500 x 560 x 700 / 720
ASSEFPL530505100 / 150 / 200	530 x 505 x 100 / 150 / 200	600 x 560 x 700 / 720
ASSEFPL530450100	530 x 450 x 100	600 x 560 x 700 / 720

Can be installed on Telescopic channel



Can be installed on Undermount runner for Solid bottom

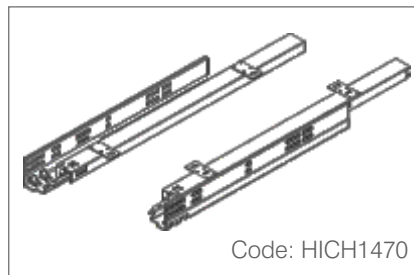

Undermount runner available only for 505mm basket

NOVA pro clips for Elnora basket



* Order Nova Pro Clip + Nova runner if you want to install basket on Nova runner

Available Heights



100mm/4"



150mm/6"



200mm/8"

SS ELNORA CUP & SAUCER BASKET

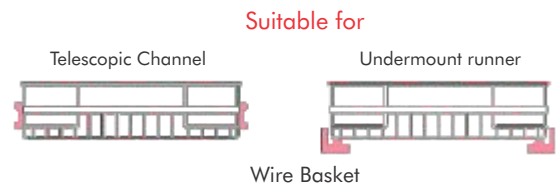
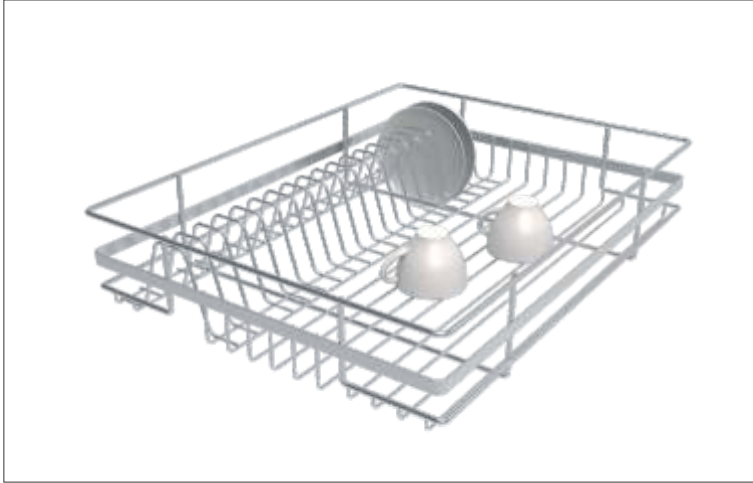

CODE NO.	DIMENSION (mm)	CABINET SIZE (mm)
	W X D x H	W X D x H
ASSECS380505100	380 x 505 x 100	450 x 560 x 700 / 720
ASSECS430505100	430 x 505 x 100	500 x 560 x 700 / 720
ASSECS530505100	530 x 505 x 100	600 x 560 x 700 / 720

SS ELNORA THALI / PLATE BASKET

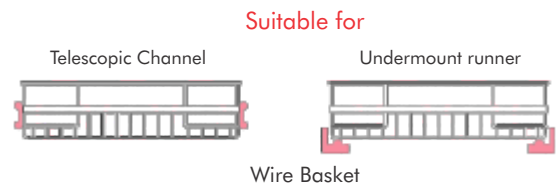
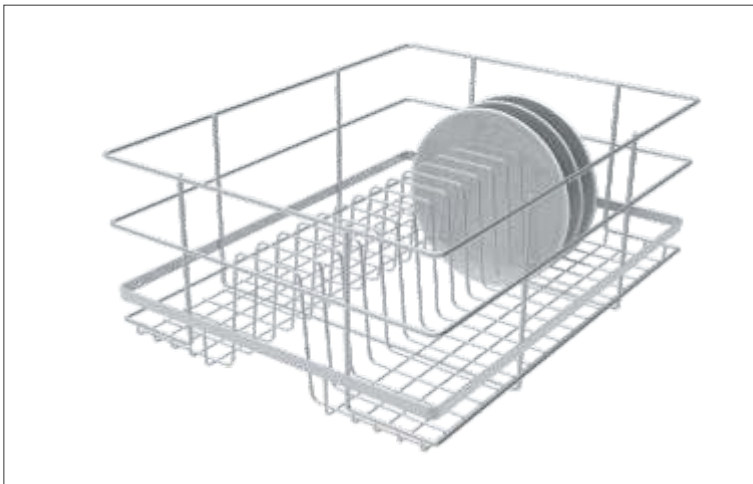

CODE NO.	DIMENSION (mm)	CABINET SIZE (mm)
	W X D x H	W X D x H
ASSETLB380505200	380 x 505 x 200	450 x 560 x 700 / 720
ASSETLB430505200	430 x 505 x 200	500 x 560 x 700 / 720
ASSETLB530505200	530 x 505 x 200	600 x 560 x 700 / 720

SS ELNORA CUTLERY BASKET

Suitable for Telescopic Channel



CODE NO.	DIMENSION (mm)	CABINET SIZE (mm)
	W X D x H	W X D x H
ASSEPCB380505100	380 x 505 x 100	450 x 560 x 700 / 720
ASSEPCB430505100	430 x 505 x 100	500 x 560 x 700 / 720
ASSEPCB530505100	530 x 505 x 100	600 x 560 x 700 / 720

SS ELNORA PERFORATED ALLIUM BASKET

Easy to Remove Basket

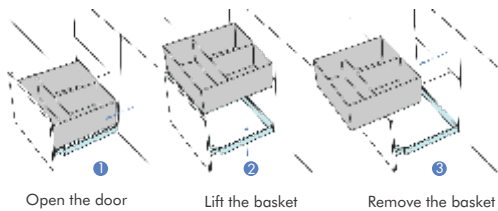

CODE NO.	DIMENSION (mm)	CABINET SIZE (mm)
	W X D x H	W X D x H
ASSEPALB380505150	380 x 505 x 150	450 x 560 x 700 / 720
ASSEPALB530505150	530 x 505 x 150	600 x 560 x 700 / 720

Note : Vegetable Allium basket cannot be fascia attached.
It needs ventilation if given inside shutter.

SS ELNORA GRAIN BASKET TROLLRY

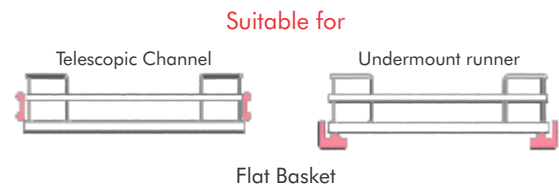
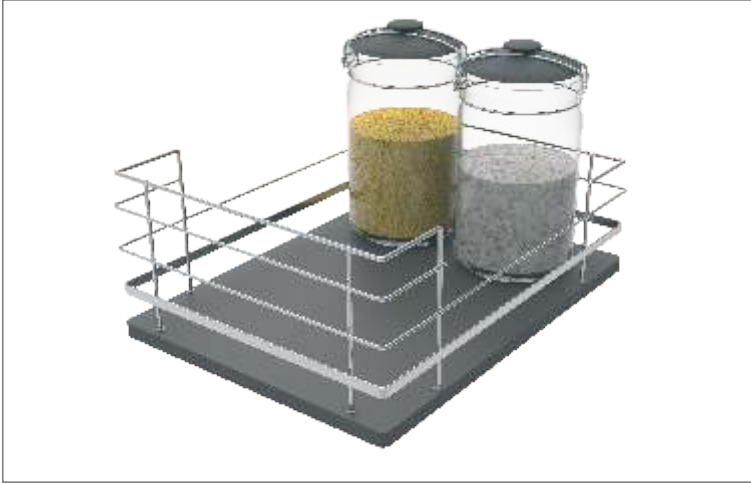

CODE NO.	DIMENSION (mm)	CABINET SIZE (mm)
	W X D x H	W X D x H
ASSEGBT380505230	380 x 505 x 230	450 x 560 x 700 / 720
ASSEGBT430505230	430 x 505 x 230	500 x 560 x 700 / 720
ASSEGBT530505230	530 x 505 x 230	600 x 560 x 700 / 720

SS ELNORA SINGLE PULL-OUT

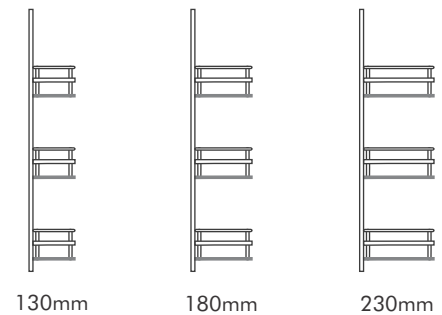

CODE NO.	DIMENSION (mm)	CABINET SIZE (mm)
	W X D x H	W X D x H
ASSESPO130515590	130 x 515 x 590	170 x 560 x 700 / 720
ASSESPO180515590	180 x 515 x 590	250 x 560 x 700 / 720
ASSESPO230515590	230 x 515 x 590	300 x 560 x 700 / 720

Note:- Comprises of three detachable baskets. Convenient to use near the cooking area to store grams, grains & spices. Product size includes telescopic channel and inbuilt channel cost.

SS ELNORA DETERGENT PULLOUT

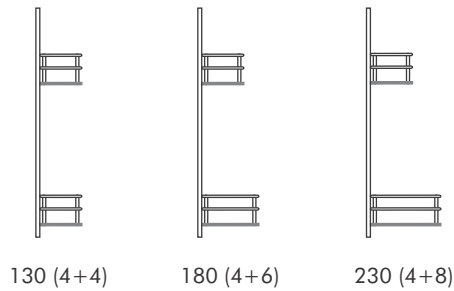

130 (4+4)

180 (4+6)

230 (4+8)



SS304

CODE NO.	DIMENSION (mm)	CABINET SIZE (mm)
	W X D x H	W X D x H
ASSEDEP130515540	130 x 515 x 540	170 x 560 x 700 / 720
ASSEDEP180515540	180 x 515 x 540	250 x 560 x 700 / 720
ASSEDEP230515540	230 x 515 x 540	300 x 560 x 700 / 720

SS BIN HOLDER



SS304

SS CODE NO.	DIMENSION (mm)
	W X D x H
ASSBIN290260145	290 x 260 x 145

Note:-Mounted on shutter just below the sink prevents any chance of litter scattering around as it swings open with the shutter.

In this we can place our own dustbin.

*Suggested to use 3 hinges, shutter width is more than 450 and height 700/720mm.

STAINLESS STEEL DUSTBIN



SS CODE NO.	DIMENSION (mm)	CAPACITY
HIGR2154	270 x 325	14 Liters

Note: Minium shutter size 400mm

SS ELNORA PREMIUM MAGIC CORNER

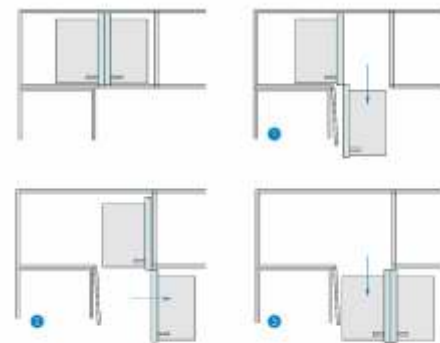

Left or right is same one

CODE NO.	DIMENSION (mm)	CABINET SIZE (mm)
	W X D X H	W X D X H
ASSEPMC700430535	700 x 430 x 535	1100 x 560 x 700 / 720

Note:- Easy access of corner space of an (L-shaped) kitchen.
 The product is interchangeable and same can be used in both blind corners.
 Includes 4 Wire Baskets
 Loading capacity 80 to 100 Kg.
 Minimum shutter opening 450mm

SS ELNORA TWIN CORNER

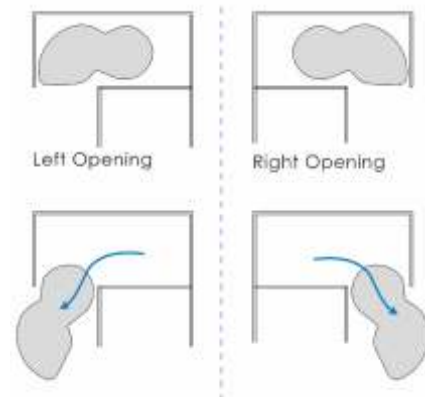

Left Opening

Right Opening

CODE NO.	DIMENSION (mm)	CABINET SIZE (mm)
	W X D	W X D x H
ASSETCR950515000	950 x 515	1100 x 560 x 700 / 720 Left Opening
ASSETCL950515000	950 x 515	1100 x 560 x 700 / 720 Right Opening

Note:- Each basket comes out fully for ease of accessibility. Solid base bottom.
 Suitable for 450mm shutter size.

SS ELNORA CARROUSEL UNIT 3/4 - 2 PCS

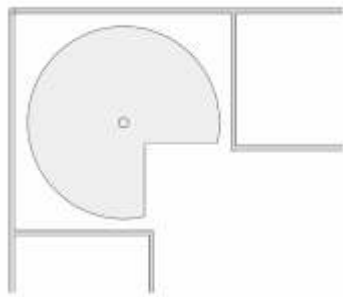

Left or right is same one



CODE NO.	DIMENSION (mm)	CABINET SIZE (mm)
	W X D x H	W X D x H
ASSECARRSL750650	ø 750 x 650 Ht.	900 x 900 x 700 / 720 L

Note:- Three-quarter round revolving basket.
 Easy access of corner space of an (L-shaped) kitchen. Baskets revolve individually.
 Shutter to open individually on 165° hinge.
 Internal clearance should be 30mm.

SS ELNORA DELUXE LARDER UNIT FULL



SS ELNORA DELUXE LARDER HALF



CODE NO.	DIMENSION (mm)	CABINET SIZE (mm)
	W X D x H	W X D x H
ASSEDLD3705051800	375 x 505 x 1650	450 x 560 x 2020

CODE NO.	DIMENSION (mm)	CABINET SIZE (mm)
	W X D x H	W X D x H
ASSEDLD3705051150	375 x 505 x 1000	450 x 560 x 1220/1320

SS PREMIUM LARDER UNIT



CODE NO.	DIMENSION (mm)	CABINET SIZE (mm)
	W X D x H	W X D x H
ASSEPREMTALLUNIT	370 x 505 x 1875-1975	450 x 560 x 2020

(With Soft Close)

designer



DESIGNER BASKET

SS DESIGNER BASKET



* The clip on the side of the basket makes installation of the basket to the channel easy.

** The clip on the fascia of the basket makes installation of the basket to the shutter easy.

CODE NO.	DIMENSION (mm)	CABINET SIZE (mm)
	W X D x H	W X D x H
20:20 Standard Module		
ASSDPL380505100 / 150 / 200	380 x 505 x 100 / 150 / 200	450 x 560 x 700 / 720
ASSDPL430505100 / 150 / 200	430 x 505 x 100 / 150 / 200	500 x 560 x 700 / 720
ASSDPL530505100 / 150 / 200	530 x 505 x 100 / 150 / 200	600 x 560 x 700 / 720
ASSDPL380605100 / 150 / 200	380 x 605 x 100 / 150 / 200	450 x 660 x 700 / 720
ASSDPL430605100 / 150 / 200	430 x 605 x 100 / 150 / 200	500 x 660 x 700 / 720
ASSDPL530605100 / 150 / 200	530 x 605 x 100 / 150 / 200	600 x 660 x 700 / 720
20:20 Non-Standard Module		
ASSDPL380405100 / 150 / 200	380 x 405 x 100 / 150 / 200	450 x 460 x 700 / 720
ASSDPL230505100 / 200	230 x 505 x 100 / 200	300 x 560 x 700 / 720
ASSDPL480505100 / 150 / 200	480 x 505 x 100 / 150 / 200	550 x 560 x 700 / 720
ASSDPL710505100 / 150 / 200	710 x 505 x 100 / 150 / 200	800 x 560 x 700 / 720
ASSDPL810505100 / 150 / 200	810 x 505 x 100 / 150 / 200	900 x 560 x 700 / 720
ASSDPL380555100 / 150 / 200	380 x 555 x 100 / 150 / 200	450 x 610 x 700 / 720
ASSDPL430555100 / 150 / 200	430 x 555 x 100 / 150 / 200	500 x 610 x 700 / 720
ASSDPL530555100 / 150 / 200	530 x 555 x 100 / 150 / 200	600 x 610 x 700 / 720

Note:- SS 304 accessories available in electro polish finish.

Can be installed on
Telescopic channel



Can be installed on
Undermount runner for Wire basket

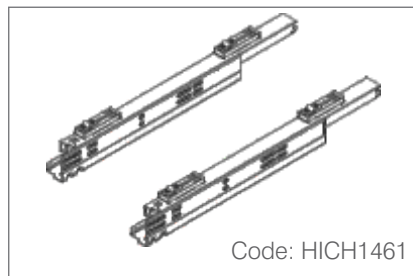

Code: HICH1461

Undermount runner available only
for 505mm basket

NOVA pro clips for
Elnora basket



Code: AMSNOVACLIPDESB

* Order Nova Pro Clip + Nova runner
if you want to install basket on
Nova runner

SS DESIGNER CUP & SAUCER BASKET



CODE NO.	DIMENSION (mm)	CABINET SIZE (mm)
	W X D x H	W X D x H
20:20 Standard Module		
ASSDCS380505100	380 x 505 x 100	450 x 560 x 700 / 720
ASSDCS430505100	430 x 505 x 100	500 x 560 x 700 / 720
ASSDCS530505100	530 x 505 x 100	600 x 560 x 700 / 720
ASSDCS380605100	380 x 605 x 100	450 x 660 x 700 / 720
ASSDCS430605100	430 x 605 x 100	500 x 660 x 700 / 720
ASSDCS530605100	530 x 605 x 100	600 x 660 x 700 / 720
20:20 Non-Standard Module		
ASSDCS380405100	380 x 405 x 100	450 x 460 x 700 / 720
ASSDCS480505100	480 x 505 x 100	550 x 560 x 700 / 720
ASSDCS380555100	380 x 555 x 100	450 x 610 x 700 / 720
ASSDCS430555100	430 x 555 x 100	500 x 610 x 700 / 720
ASSDCS530555100	530 x 555 x 100	600 x 610 x 700 / 720

SS DESIGNER THALI / PLATE BASKET



CODE NO.	DIMENSION (mm)	CABINET SIZE (mm)
	W X D x H	W X D x H
20:20 Standard Module		
ASSDTP380505200	380 x 505 x 200	450 x 560 x 700 / 720
ASSDTP430505200	430 x 505 x 200	500 x 560 x 700 / 720
ASSDTP530505200	530 x 505 x 200	600 x 560 x 700 / 720
ASSDTP380605150	380 x 605 x 150	450 x 660 x 700 / 720
ASSDTP430605150	430 x 605 x 150	500 x 660 x 700 / 720
ASSDTP530605150	530 x 605 x 150	600 x 660 x 700 / 720
20:20 Non-Standard Module		
ASSDTP480505200	480 x 505 x 200	550 x 560 x 700 / 720
ASSDTP380555150	380 x 555 x 150	450 x 610 x 700 / 720
ASSDTP430555150	430 x 555 x 150	500 x 610 x 700 / 720
ASSDTP530555150	530 x 555 x 150	600 x 610 x 700 / 720

SS PERFORATED CUTLERY BASKET

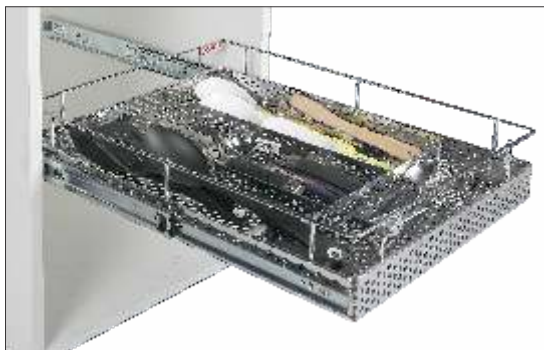

CODE NO.	DIMENSION (mm)	CABINET SIZE (mm)
	W X D x H	W X D x H
20:20 Standard Module		
ASSPCB380505100	380 x 505 x 100	450 x 560 x 700 / 720
ASSPCB430505100	430 x 505 x 100	500 x 560 x 700 / 720
ASSPCB530505100	530 x 505 x 100	600 x 560 x 700 / 720
ASSPCB380605100	380 x 605 x 100	450 x 660 x 700 / 720
ASSPCB430605100	430 x 605 x 100	500 x 660 x 700 / 720
ASSPCB530605100	530 x 605 x 100	600 x 660 x 700 / 720
20:20 Non-Standard Module		
ASSPCB380405100	380 x 405 x 100	450 x 460 x 700 / 720
ASSPCB480505100	480 x 505 x 100	550 x 560 x 700 / 720
ASSPCB710505100	710 x 505 x 100	800 x 560 x 700 / 720
ASSPCB810505100	810 x 505 x 100	900 x 560 x 700 / 720
ASSPCB380555100	380 x 555 x 100	450 x 610 x 700 / 720
ASSPCB430555100	430 x 555 x 100	500 x 610 x 700 / 720
ASSPCB530555100	530 x 555 x 100	600 x 610 x 700 / 720

SS GRAIN BASKET



CODE NO.	DIMENSION (mm)	CABINET SIZE (mm)
	W X D x H	W X D x H
20:20 Standard Module		
ASSGBT510505230	510 x 505 x 230	600 x 560 x 700 / 720
20:20 Non-Standard Module		
ASSGBT360505230	360 x 505 x 230	450 x 560 x 700 / 720
ASSGBT410505230	410 x 505 x 230	500 x 560 x 700 / 720

Note:- This product includes bracket set and channel cost is extra.

WICKER BASKET



CODE NO.	DIMENSION (mm)	CABINET SIZE (mm)
	W X D x H	W X D x H
ASSWICKERBSK000	550 X 530 X 150	600 X 560 X 700 / 720

Note : Wicker basket cannot be fascia attached.
It needs ventilation if given inside shutter.

SS SINGLE PULL-OUT



CODE NO.	DIMENSION (mm)	CABINET SIZE (mm)
	W X D x H	W X D x H
20:20 Standard Module		
ASSSPO160510585	155 x 515 x 590	200 x 560 x 700 / 720
ASSSPO180510585	180 x 515 x 590	250 x 560 x 700 / 720
ASSSPO230510585	230 x 515 x 590	300 x 560 x 700 / 720
20:20 Non-Standard Module		
ASSSPO180410585	180 x 410 x 590	250 x 460 x 700 / 720
ASSSPO130510585	130 x 515 x 590	170 x 560 x 700 / 720

Note:- Comprises of three detachable baskets. Convenient to use near the cooking area to store grams, grains & spices. Product size includes telescopic channel and inbuilt channel cost.

SS DETERGENT PULL OUT



CODE NO.	DIMENSION (mm)	CABINET SIZE (mm)
	W X D x H	W X D x H
20:20 Standard Module		
ASSDEP180510485	180 x 510 x 485	250 x 560 x 700 / 720
ASSDEP230510485	230 x 510 x 485	300 x 560 x 700 / 720
ASSDEP230510485 (4/8)	230 x 515 x 540	300 x 560 x 700 / 720
20:20 Non-Standard Module		
ASSDEP130510485	130 x 510 x 485	170 x 560 x 700 / 720
ASSDEP160510485	155 x 510 x 485	200 x 560 x 700 / 720

SS TWIN CORNER (RIGHT/LEFT)

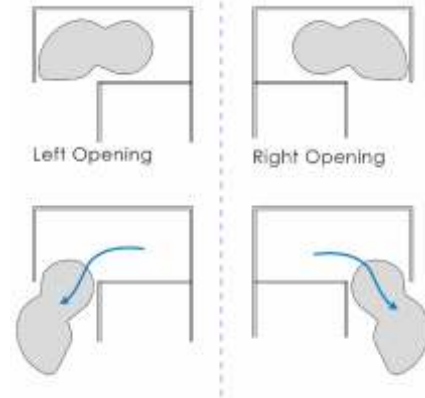

CODE NO.	DIMENSION (mm)	CABINET SIZE (mm)
	W X D	W X D x H
ASSTCL950515000	950 x 515	1100 x 560 x 700 / 720 Right Opening
ASSTCR950515000	950 x 515	1100 x 560 x 700 / 720 Left Opening

Note:- Each basket comes out fully for ease of accessibility. Solid base bottom.
Need To Mention Right Opening or Left Opening.
Suitable for 450mm shutter size.

SS CARROUSEL UNIT 3/4 - 2 PCS

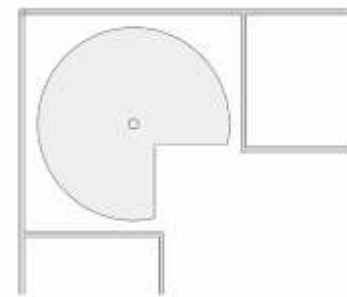

CODE NO.	DIMENSION (mm)	CABINET SIZE (mm)
	W X D x H	W X D x H
ASSCARRSL650650	ø 650 x 664 / 684 Ht.	900 x 900 x 700 / 720 L
ASSCARRSL750650	ø 750 x 664 / 684 Ht.	900 x 900 x 700 / 720 L

Note:- Three-quarter round revolving basket.
Easy access of corner space of an (L-shaped) kitchen. Baskets revolve individually.
Shutter to open individually on 165° hinge.
Internal clearance should be 30mm.

SS MAGIC CORNER (RIGHT/LEFT)

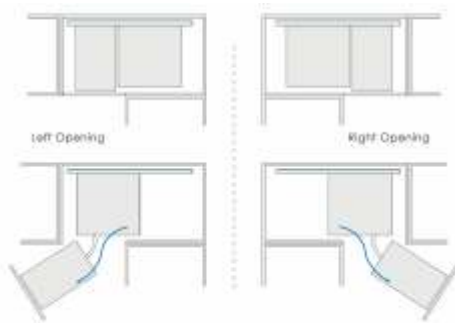

CODE NO.	DIMENSION (mm)	CABINET SIZE (mm)
	W X D X H	W X D X H
ASSMGC910490540	910 X 490 X 540	1100 X 580 X 700 / 720 RIGHT OPENING
ASSMGC911490540	910 X 490 X 540	1100 X 580 X 700 / 720 LEFT OPENING

Note:- Easy access of corner space of an (L-Shape) Kitchen.
 Need To Mention Right Blind or Left Blind.
 Loading capacity 80 to 100 Kg.
 Minimum shutter opening 450mm

SS PREMIUM MAGIC CORNER

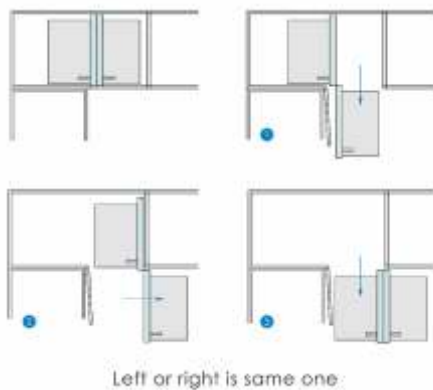

CODE NO.	DIMENSION (mm)	CABINET SIZE (mm)
	W X D X H	W X D X H
ASSPMC700430535	700 x 430 x 535	1100 x 560 x 700 / 720

Note:- Easy access of corner space of an (L-shaped) kitchen.
 The product is interchangeable and same can be used in both blind corners.
 Includes 4 Wire Baskets.
 The product image is for only representation purpose.
 Loading capacity 80 to 100 Kg.
 Minimum shutter opening 450mm

SS DELUXE LARDER UNIT



CODE NO.	DIMENSION (mm)	CABINET SIZE (mm)
	W X D x H	W X D x H
ASSDLUBSK45	375 x 505 x 1650	450 x 560 x 2020

Note:- Loading capacity 80 to 100 Kg.
*Suggested to use 165° hinge

SS HALF LARDER PULLOUT

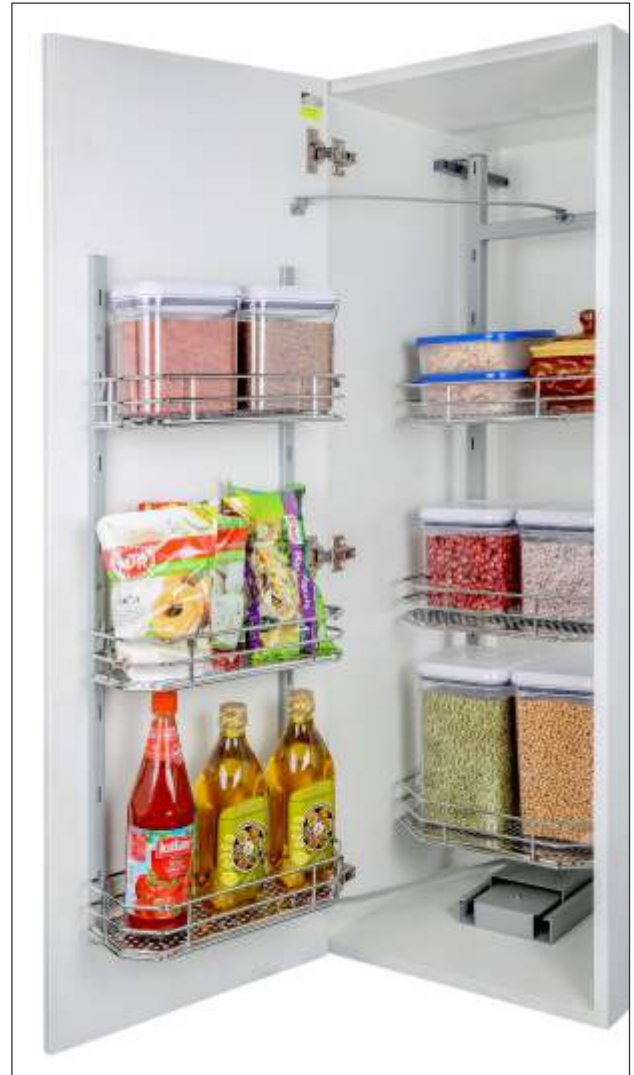

CODE NO.	DIMENSION (mm)	CABINET SIZE (mm)
	W X D x H	W X D x H
ASSHDL3705101275	375 x 505 x 1000	450 x 560 x 1220/1320
ASSDLD3705051800	525 x 505 x 1000	600 x 560 x 1220/1320

Note:- Half Deluxe Larder Unit has set of 3 baskets each.
Loading capacity 80 to 100 Kg.
* Suggested to use 165°hinge
* Baskets of Half delux larder for 600 mm cabinet are of wire structure (No Perforation)

SS PREMIUM LARDER UNIT



SS CODE NO.	DIMENSION (mm)	CABINET SIZE (mm)
	W X D x H	W X D x H
ASSPLD3705051975	370 x 505 x 1875-1975	450 x 560 x 2020 (w/o Soft Close)
ASSPLD3705051875	370 x 505 x 1875-1975	450 x 560 x 2020 (with Soft Close)

Note : Suited for width 450mm, H 1875~1975 ,
Cabinet size 1920 ~ 2020, Basket size 400 x 86,
Tall consists of frame, 3 brackets, two front rails and five baskets.
Loading capacity 80 to 100 Kg.

SS GLASS TRAY / PLATE TRAY



SS CODE NO.	DIMENSION (mm)	CABINET SIZE (mm)
	W X D X H	W X D X H
20:20 Standard Module		
ASSGPR405255100	405 x 255 x 100	450 x 330 x 600/720
ASSGPR555255100	555 x 255 x 100	600 x 330 x 600/720
ASSGPR855255100	855 x 255 x 100	900 x 330 x 600/720
20:20 Non-Standard Module		
ASSGPR456255100	456 x 255 x 100	500 x 330 x 600/720
ASSGPR605255100	605 x 255 x 100	650 x 330 x 600/720
ASSGPR660255100	660 x 255 x 100	700 x 330 x 600/720
ASSGPR710255100	710 x 255 x 100	750 x 330 x 600/720
ASSGPR755255100	755 x 255 x 100	800 x 330 x 600/720

Note: GTPT Supports Included with the set.

DRIP TRAY (For Wall & Base Cabinet)



CODE NO.	DESCRIPTION	PRODUCT DIMENSION(mm)
	W X D X H	W X D X H
20:20 Standard Module		
AMSDTY39524515	Drip Tray 45cm (Wall)	395 x 245 x 15
AMSDTY54024515	Drip Tray 60cm (Wall)	540 x 245 x 15
AMSDTY83024515	Drip Tray 90cm (Wall)	830 x 245 x 15
20:20 Non-Standard Module		
AMSDTY43024515	Drip Tray 50cm (Wall)	430 x 245 x 15
AMSDTY59024515	Drip Tray 65cm (Wall)	590 x 245 x 15
AMSDTY63024515	Drip Tray 70cm (Wall)	630 x 245 x 15
AMSDTY67524515	Drip Tray 75cm (Wall)	675 x 245 x 15
AMSDTY72524515	Drip Tray 80cm (Wall)	675 x 245 x 15
AMSDTY40551515	Drip Tray 45cm (Base)	405 x 515 x 15
AMSDTY45051515	Drip Tray 50cm (Base)	450 x 515 x 15
AMSDTY53551515	Drip Tray 60cm (Base)	535 x 515 x 15

Executive Cutlery Tray



CODE NO.	PRODUCT	BOTTOM DIMENSION	DIMENSION (mm)
		W X D	W X D X H
AMSECI19048560	Ex. Cut 30*55	165 X 53	190 X 485 X 60
AMSECI39047060	Ex. Cut 45*55 Deep	325 X 415	400 X 500 X 60
AMSECI55050060	Ex. Cut 55*55 Inclined	460 X 395	550 X 490 X 60
AMSECI43050060	Ex. Cut 50*55	345 X 405	430 X 500 X 60
AMSECI83549560	Ex. Cut 90*55	745 X 445	830 X 500 X 60

SS DETERGENT HOLDER



SS CODE NO.	DIMENSION (mm)
	W X D x H
ASSDEH230200390	230 x 200 x 390

Note :- SS 304 accessories available in electro polish finish.

SS CYLINDER TROLLEY



SS CODE NO.	DIMENSION (mm)
	W X D x H
ASSCYT000320100	Dia 320 x 100

Note : SS 304 accessories available in electro polish finish.

**SS GLASS HOLDER
(2 RAIL)**



CODE NO. DIMENSION (mm)

W X D x H

ASSGLHOLDER2RAIL 250 x 215 x 60

**SS CORNER RACK
(DOUBLE TIER)**



CODE NO. DIMENSION (mm)

W X D x H

ASSCORRACK2TIER 310 x 340 x 450

SS CUP & SAUCER HOLDER



CODE NO. DIMENSION (mm)

W X D x H

ASSCSHOLDER 410 x 260 x 310

**SS MULTI-PURPOSE
PLATE RACK**



CODE NO. DIMENSION (mm)

W X D x H

ASSMULTIPURPLRA 610 x 320 x 380

**SS UTILITY SHELF
(DOUBLE TIER)**



CODE NO. DIMENSION (mm)

W X D x H

ASSUTSHELF2TIER 405 x 135 x 450

SS GLASS STAND



CODE NO. DIMENSION (mm)

W X D x H

ASSGLASSSTAND 240 x 90 x 425

SS CUTLERY HOLDER



CODE NO. DIMENSION (mm)

W X D x H

ASSCUTLERYHOLDR 120 x 160 x 375

SS DUAL SPOON HOLDER



CODE NO. DIMENSION (mm)

W X D x H

ASSDUALSPOONHOL 156 x 108 x 300

**SS MULTI-PURPOSE
(SINGLE TIER)**



CODE NO. DIMENSION (mm)

W X D x H

ASSMULTIPUR1TIER 456 x 170 x 300

Note: These products are available in SS 304 electro polish finish.

**SS MULTI-PURPOSE
(2 RAIL)**



CODE NO. DIMENSION (mm)

W X D x H

ASSMULTIPUR2TIER 456 x 170 x 450

**SS TISSUE PAPER HOLDER
(2 TIER CUTTER)**



CODE NO. DIMENSION (mm)

W X D x H

ASSTISSUEPAPER2 330 x 165 x 430

**SS TISSUE PAPER HOLDER
(2 TIER CUTTER)**



CODE NO. DIMENSION (mm)

W X D x H

ASSWDCHPBKDNFHD 310 x 85 x 450

**WOODEN MULTI-PURPOSE
HOLDER**



CODE NO. DIMENSION (mm)

W X D x H

ASSWOODENMULTIH 270 x 140 x 310

**SS CLEANING UTENSIL
HOLDER**



CODE NO. DIMENSION (mm)

W X D x H

ASSCLNUTENHOLDR 230 x 100 x 60

**SS TABLE MOUNTED
PLATE & BOWL**



CODE NO. DIMENSION (mm)

W X D x H

ASSTBEMTPL&BOWL 315 x 215 x 315

Note: These products are available in SS 304 chrome finish.

HARDWARE FOR MIDWAY ACCESSORIES

SS TUBE HOLDER CONNECTOR



Code: ASSTUBHOLCON000
Size: 20 x 20 x 50 (W x D x H)

SS TUBE HOLDER SET (L & R)



Code: ASSTUBHOLSET000
Size: 20 x 20 x 50 (W x D x H)

SS S-HOOK



Code: ASS000SHOOK0000
Size: 40 x 05 x 72 (W x D x H)

SS BEND FOR 16MM PIPE



Code: ASSBEND16MMPIPE
Size: Dia16 x 80 x 80 (W x D x H)

SS PIPE



Code: ASSPOP00002FEET
Size: 2' L/600mm, 16mm Dia
Code: ASSPOP00003FEET
Size: 3' L/900mm, 16mm Dia
Code: ASSPOP00004FEET
Size: 4' L/1200mm, 16mm Dia

Sleek's International Tie-ups



FREELIFT: INTELLIGENT ENGINEERING IN A CLASS OF ITS OWN

Reliable power, slimline designs, strong performance

Advanced, Slim, Precise. The most advanced lifter family on the market meets all the criteria for looks and functionality. Aesthetics is an emotional criterion that even technical products must achieve today. They have to perform perfectly and look beautiful too.

The slim and elegant looks of the different members of the FREElift family underline the obvious advantages of Kesseböhmer's high-precision technology. Specialists in the contemporary look.

The FREElift lifter family delivers silky smooth opening and closing action for wall cabinets with a wide range of flap sizes and weights. The easy and harmonious movements are quiet, soft and effortless-these outstanding characteristics represent striking benefits to the user.

FREE FOLD



Advantages

- Specially developed for tall wall units
- Also for low ceilings and heavy fronts
- Ideal for transparent glass fronts and units with interior lighting
- Safety hinges on the fold to prevent any risk of finger pinching
- Multi-Position-STOPP
- E-Senso system which opens the front automatically with just a light tap

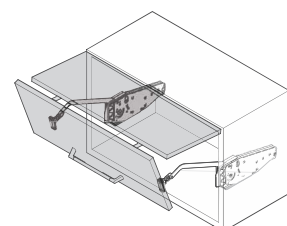

SAP CODE	PRODUCT DESCRIPTION	CABINET SIZE	WEIGHT CAPACITY
HILP5088	KBR Free Fold	580-650mm	4.3 - 9.2Kg
HILP5089	KBR Free Fold	650-730mm	5.8 - 12.2Kg

FREE FLAP MINI / FORTE



Advantages

- Minimal installation depth (118 mm)
- Generates force to lift 27 kg
- 90° & 107° opening angles
- Multi-Position-STOPP

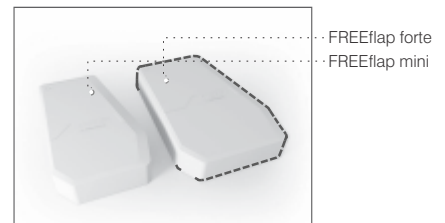

SAP CODE	PRODUCT DESCRIPTION	CABINET SIZE	WEIGHT CAPACITY
HILP5080	KBR Free Forte - G	≥350 - ≥650	6.9 - 27.3
HILP5102	KBR Free Forte - D	≥350 - ≥650	2.6 - 11.0
HILP5100	KBR Free Mini - B	≥200 - ≥420	1.4 - 7.9

FREE SWING



Advantages

- Impressive range of applications for medium and large fronts
- Effortless movement sequences
- Optimal access to whole storage space
- Multi-Position-STOPP

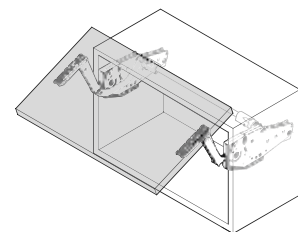

SAP CODE	PRODUCT DESCRIPTION	CABINET SIZE	WEIGHT CAPACITY
HILP5090	KBR Free Swing	500-670mm	4.5 - 10.6Kg
HILP5091	KBR Free Swing	670-800mm	5.3 - 11.8Kg

FREE FLAP HUWILIFT DUO



Advantages

- Holding force can be set steplessly
- Mount for either flap support or bar counter function
- Identical left or right mounting for quick and easy assemble



SAP CODE	PRODUCT DESCRIPTION	CABINET HEIGHT	WEIGHT CAPACITY
HILP5092	KBR Huwilift Duo	Normal	1 - 9.4

FREEflap Huwilift Maxi



Advantages

- Designed to take the load – lifts even heavy front panels effortlessly
- Use right or left – simplifies logistics and assembly
- Holding force can be set precisely
- Multi-Position-STOPP



SAP CODE	PRODUCT DESCRIPTION	CABINET SIZE	WEIGHT CAPACITY
HILP5096	KBR Huwilift Maxi	Normal	1- 9.4

Add a touch of Sleek elegance to your kitchen with GRASS

Nova Pro - Benefits for all

Hygiene



Hygiene is a major requirement in any kitchen. With Grass Nova, the non-toxic coating and the narrow cleaning lip, that's no problem at all.

Weight Carrying Capacity



High Weight carrying capacity

High Storage



Due to straight sides utilisation of additional 30mm space. If we count 30mm X 500mm Depth in 13 drawers, total space saving could be equivalent to 1 complete drawer

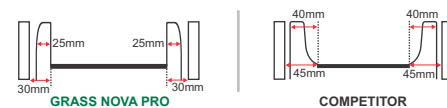

Installing and removing

One single movement completes installation and removal of a Nova drawer. There are no levers involved.



Front installation + removal (tool-free)

The drawer front panel can be attached or removed with one movement. Simple and tool-free!

Assembly

1. Angle the front panel with the installation hooks into the lower slanted slot. (0-positioning with the installation hooks).
2. Tilt the front in and...
3. ...Press down.

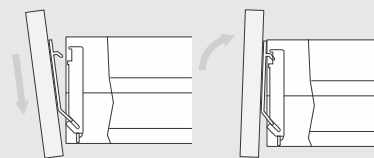

Removing

1. Press the catch and ...
2. ... Remove front panel.

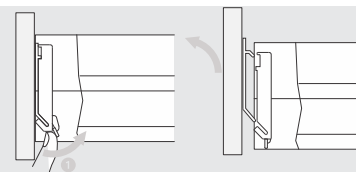

Nova Pro - Features

- GREATER STABILITY
- BETTER SLIDING
- MINIMUM PULLOUT FORCE
- BETTER SYNCHRONISATION
- ONE SIZE BENEFITS ALL!

FULL EXTENSION 40 AND 70 KG

Grass Nova Pro Add-ons

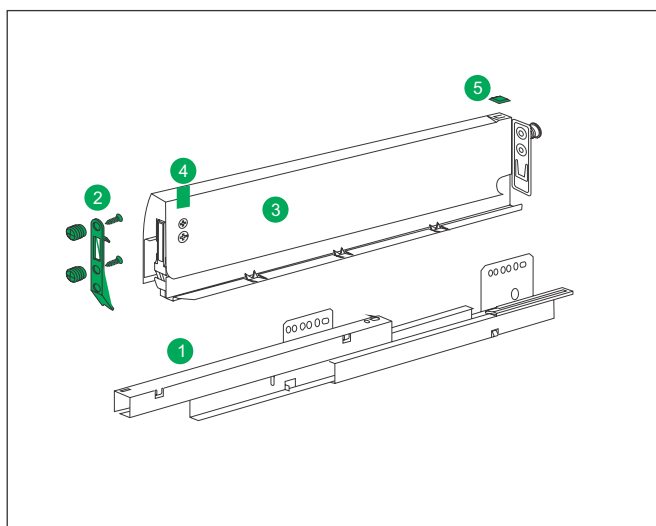
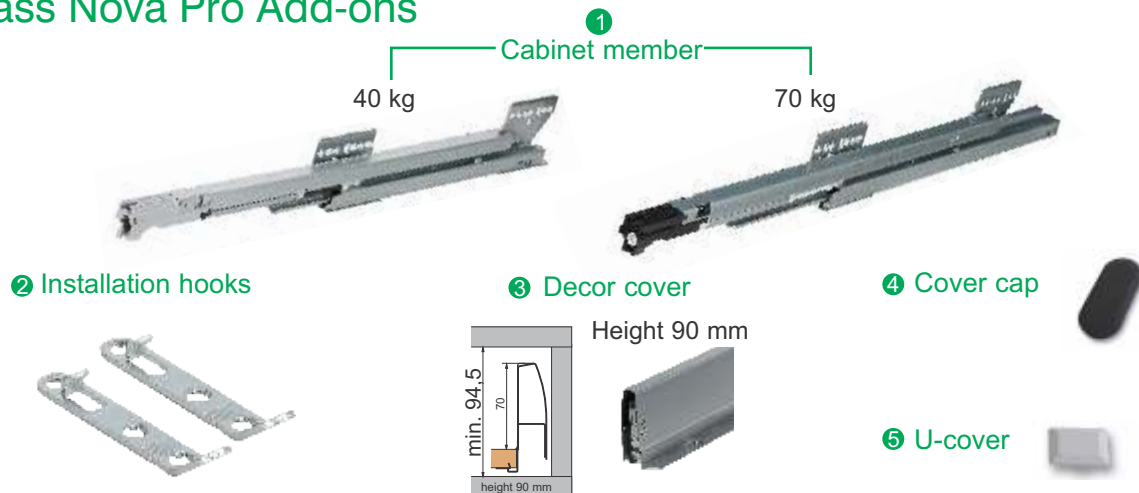

NOVA INNER DRAWER FRONT BRACKET FOR RAILING

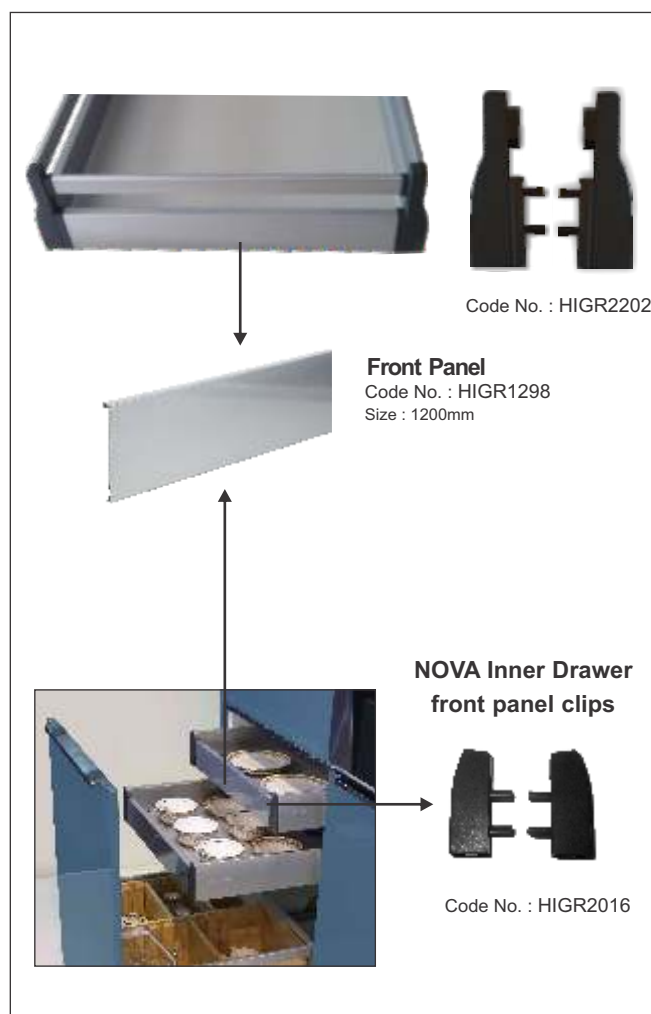

NOVA PRO CLIPS FOR DESIGNER BASKET



Grass Nova Pro Add-ons

Nova Pro Channel



One Side Railing



Dividing Railing



High Front Railing



Inner Drawer without Railing



Inner Drawer with Railing



Nova Crystal



Nova Crystal inner drawer



Cutlery Organiser B4



NOVA PRO - SIZES AVAILABLE

SIZES (MM)	NOVA PRO 40KG	NOVA MEMBER 40KG	NOVA PRO 70KG	NOVA MEMBER 70KG	RECTANGULAR RAILING
350	HIGR2059	HIGR2047	-	-	-
400	HIGR2060	HIGR1279	-	-	HIGR2071
450	HIGR2061	HIGR2049	-	-	HIGR2072
500	HIGR2062	HIGR2050	HIGR2063	HIGR2053	HIGR2073
550	HIGR2064	HIGR2052	HIGR2065	HIGR2054	HIGR2074
600	HIGR2066	HIGR2051	HIGR2067	HIGR2055	HIGR2075

Grass Nova Pro Wooden Add-ons



WOODEN PARTAGE

CODE NO.	DIMENSION (MM)
	W x H
ASSWDPART60W003	FOR 600 CABINETS
ASSWDPART90W004	FOR 900 CABINETS



100 X 480 X 150



200 X 480 X 150



200 X 240 X 150

Note: Always available as entire set not as a kit.

WOODEN ADJUSTABLE PARTAGE

CODE NO.	DIMENSION (MM)
	W x H
ASSWDPARTAGE060	FOR 600 CABINETS



WOODEN ORGANISER

CODE NO.	DIMENSION (MM)
	W x H
ASSWOP51050550	FOR 600 CABINETS
ASSWOP81050550	FOR 900 CABINETS



PEG-100MM HT



140 X 100



200 X 100



430 X 100

Note: Always available as entire set not as a kit.

EUROPEAN BIN



CODE NO .	DIMENSION (mm)	CABINET SIZE (mm)
-----------	----------------	-------------------

HISG7037	250 x 320	13 Liters
----------	-----------	-----------

Note: · Shutter Mounting
· Minium shutter size 400mm

EUROPEAN PULLOUT WASTE BIN-28Ltr.



CODE NO .	DIMENSION (mm)	CABINET SIZE (mm)
-----------	----------------	-------------------

HISG7006	For 450 mm	28 Liters
----------	------------	-----------

Note: Bottom Mounting

EUROPEAN UNDER SINK KIT



CODE NO.	CABINET SIZE (mm)
----------	-------------------

HIGR2164	For 900 mm (IT-103)
----------	---------------------

Note: Made of Varnished Aluminum
Suitable for Nova pro runners, which have to be ordered separately, Code No. NPA4050

EUROPEAN UNDER SINK DUST BIN KIT



CODE NO.	CABINET SIZE (mm)
----------	-------------------

HIGR2153	For 900 mm (IT-104)
----------	---------------------

Note: Suitable for Nova Pro Runners
Made of Varnished Aluminum
Suitable for Nova pro runners, which have to be ordered separately, Code No. NPA4050

EUROPEAN DISH RACK



CODE NO.	CABINET SIZE (mm)
----------	-------------------

HIGR2158	For 900 mm (IT-109)
----------	---------------------

HIGR2151	For 600 mm (IT-106)
----------	---------------------

Note: AISI 304 Grade Racks

EUROPEAN DRAWER SYSTEM PLATE & BOWL ORGANIZER 90



CODE NO.	CABINET SIZE (mm)
----------	-------------------

HIGR2155	For 900 mm (IT-111)
----------	---------------------

HIGR2156	For 600 mm (IT-110)
----------	---------------------

Note: AISI 304 Grade
Suitable for Nova pro runners, which have to be ordered separately, Code No. NPA4050

EUROPEAN DRAWER SYSTEM CUTLERY ORGANIZER 90



CODE NO.	CABINET SIZE (mm)
----------	-------------------

HIGR2163	For 900 mm (IT-101)
----------	---------------------

Note: Suitable for Nova Pro Drawer

EUROPEAN DRAWER SYSTEM - CUTLERY ORGANIZER 60



CODE NO.	CABINET SIZE (mm)
----------	-------------------

HIGR2152	For 600 mm (IT-102)
----------	---------------------

Note: Suitable for Nova Pro Drawer

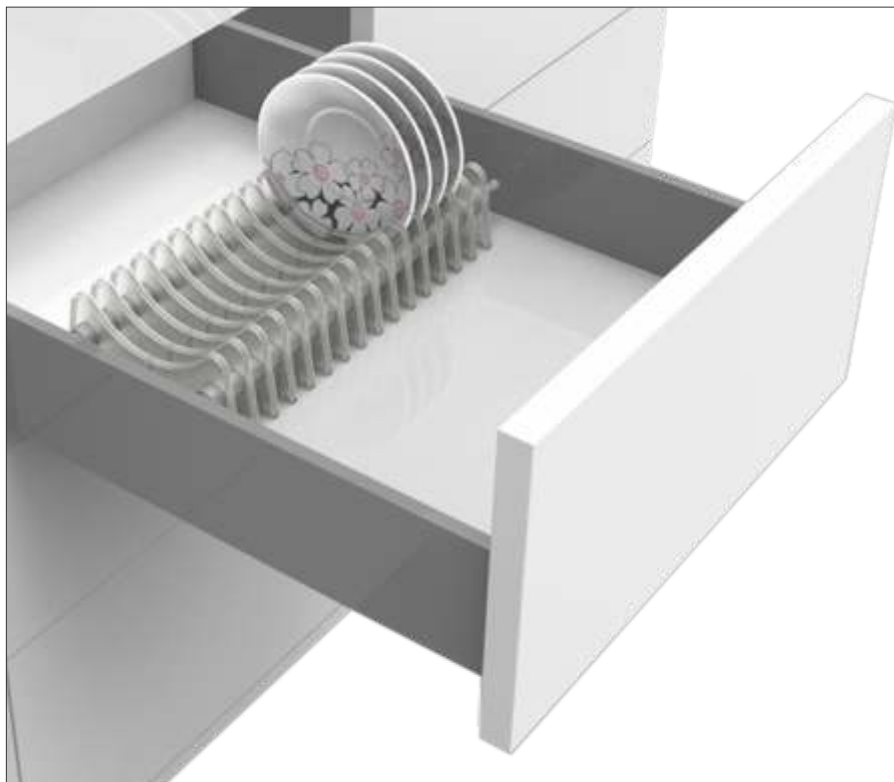

Crown

Series of Drawer Add-Ons

Features

- Stable Design
- Light Weight
- Easy to Clean & Maintain
- Customizable
- Economical
- Long Life
- Adaptability



PLATE HOLDER



SAUCER HOLDER



THALI HOLDER



THALI/PLATE COMBO

DRAWER INSERTS*

Cabinet Size (mm)	Code	Description	Drawer internal clear space**(mm)	Std. Pack
450	ASSPLHOLD360	CROWN PLATE HOLDER	360 to 370	1
450	ASSCSHOLD360	CROWN SAUCER HOLDER	360 to 370	1
450	ASSTHHOLD360	CROWN THALI HOLDER	360 to 370	1
450	ASSTPCOMB360	CROWN THALI PLATE COMBO	360 to 370	1
500	ASSPLHOLD410	CROWN PLATE HOLDER	410 to 420	1
500	ASSCSHOLD410	CROWN SAUCER HOLDER	410 to 420	1
500	ASSTHHOLD410	CROWN THALI HOLDER	410 to 420	1
500	ASSTPCOMB410	CROWN THALI PLATE COMBO	410 to 420	1
600	ASSPLHOLD510	CROWN PLATE HOLDER	510 to 520	1
600	ASSCSHOLD510	CROWN SAUCER HOLDER	510 to 520	1
600	ASSTHHOLD510	CROWN THALI HOLDER	510 to 520	1
600	ASSTPCOMB510	CROWN THALI PLATE COMBO	510 to 520	1
900	ASSPLHOLD810	CROWN PLATE HOLDER	810 to 820	1
900	ASSTHHOLD810	CROWN THALI HOLDER	810 to 820	1
900	ASSTPCOMB810	CROWN THALI PLATE COMBO	810 to 820	1

*This will fit in Nova Pro & Tuff Advance baskets. May also be used as countertop stand.

**End to end space between inner walls of a drawer

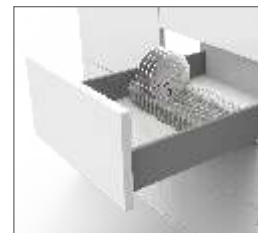

Width Wise

Channel Depth	Code	Description	Drawer internal clear space**(mm)	Std. Pack
500	ASSPLHOLD485	CROWN PLATE HOLDER	485 to 495	1
500	ASSCSHOLD485	CROWN SAUCER HOLDER	485 to 495	1
500	ASSTHHOLD485	CROWN THALI HOLDER	485 to 495	1
500	ASSTPCOMB485	CROWN THALI PLATE COMBO	485 to 495	1

*This will fit in Nova Pro & Tuff Advance baskets. May also be used as countertop stand.

**End to end space between inner walls of a drawer

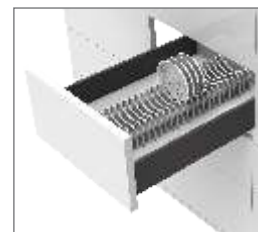

Depth Wise

Scilm has operated for over 30 years in the kitchen component market and supplies the major Italian and European brands. This success has been achieved thanks to technology, taste and the made in Italy style that distinguishes us. We offer quality products for Indian homes that are quickly assembled, modular and render kitchens practically eternal. The products imported from Scilm are entirely made in Italy. Scilm meets the most severe environmental regulations and has the ISO certification for quality and environmental systems.

PVC Skirting



CODE NO.	DIMENSION (MM)	FINISH
R460010A1101F	100 mm	Matt Aluminum
R4600A15A11/F	150 mm	Matt Aluminum
R460010A1501F	100 mm	Mirror Finish
R4600A15A15/F	150 mm	Mirror Finish
R46001070601	100 mm	Black
R46001570601	150 mm	Black
R46001088201F	100 mm	Glossy White
R46001588201F	150 mm	Glossy White

Linear Skirting Connector



CODE NO.	DIMENSION (MM)	FINISH
431-97-A11SF	100 mm	Matt Aluminum
431-147-A11SF	150 mm	Matt Aluminum
431-97-706SF	100 mm	Black
431-147-706SF	150 mm	Black

* Connects 2 skirting

Ventilation Grill for Skirting



CODE NO.	FINISH
GR991-02	White
GR991-06	Black
GR991-07	Gray

Cover Profile for Skirting



CODE NO.	FINISH
GR992-02	White
GR992-06	Black
GR992-07	Gray

The inbuilt dishwasher & washing machine shutter hits the skirting on opening and the skirting comes off. To avoid, the skirting needs to be cut and this cover profile is used to nish the cutout.

Corner Profile (Multi)



CODE NO.	DIMENSION (MM)	FINISH
426A-97-A11SF	100 mm	Matt Aluminum
426A-147A11SF	150 mm	Matt Aluminum
426A-147A15SF	150 mm	Mirror Finish
426A-97-706SF	100 mm	Black
426A-147706SF	150 mm	Black
426A-147882SF	150 mm	Glossy White

*The PVC foil is designed to bend over the edge and this gives a clean, nished look. The foil will not peel with normal wear and tear.

*Very easy to install for external skirting corner joint (Only one skirting has to be attached to the corner profile & 2nd skirting will get overlap by the corner profile.)

SCILM GOLA PROFILES

ALUMINUM GOLA PROFILE J CHANNEL

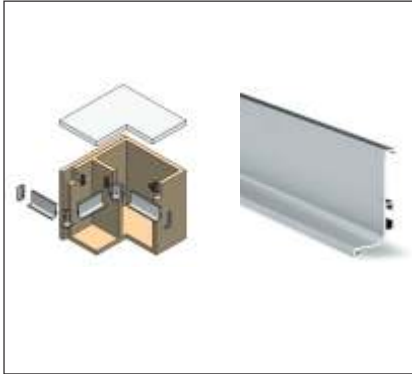

CODE NO.	DIMENSION	FINISH
800650SL41	1 Length=2.05 Mtr.	Matt
8006LU5L41	1 Length=2.05 Mtr.	Chrome

ALUMINUM GOLA PROFILE C CHANNEL

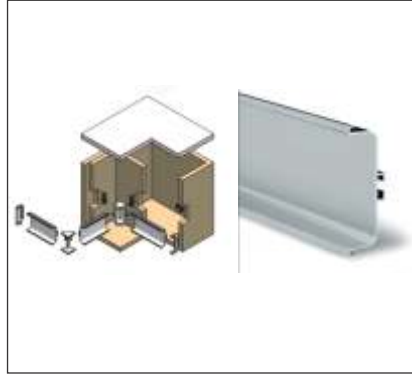

CODE NO.	DIMENSION	FINISH
800750SL41	1 Length=2.05 Mtr.	Matt
8007LU5L41	1 Length=2.05 Mtr.	Chrome

ALUMINUM VERTICAL GOLA PROFILE



CODE NO.	DIMENSION	FINISH
----------	-----------	--------

End Vertical Gola Profile

801850SL45	1 Length=2.05 Mtr.	Matt
8018LU5L45	1 Length=2.05 Mtr.	Chrome

Center Vertical Gola Profile

801250SL45	1 Length=2.05 Mtr.	Matt
8012LU5L45	1 Length=2.05 Mtr.	Chrome



SCILM GOLA PROFILES

ALUMINUM CORNER FOR GOLA



CODE NO.	FINISH
AG8006-50S	Matt
AG8006-LU5	Chrome LU5

ALUMINUM CORNER FOR GOLA

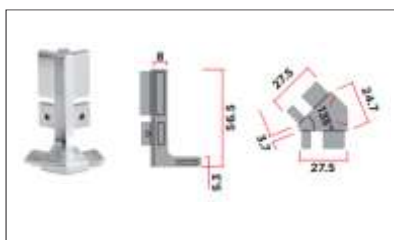

CODE NO.	FINISH
SG8006-50S	Matt
SG8006-LU5	Chrome LU5

ALUMINUM CORNER FOR GOLA



CODE NO.	FINISH
AG8007-50s	Matt
AG8007-LU5	Chrome LU5

ALUMINUM CORNER FOR GOLA

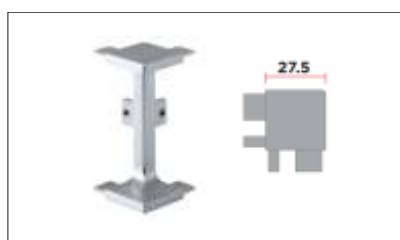

CODE NO.	FINISH
SG8007-50S	Matt
SG8007-LU5	Chrome LU5

OPEN MODEL CLOSING CAP

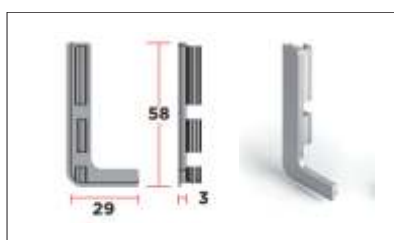

CODE NO.	FINISH
CF8006TP50S-L	Matt
CF8006TPLU5-L	Chrome LU5

OPEN MODEL CLOSING CAP



CODE NO.	FINISH
CF8006TP50S-R	Matt
CF8006TPLU5-R	Chrome LU5

CLOSE MODEL CLOSING CAP

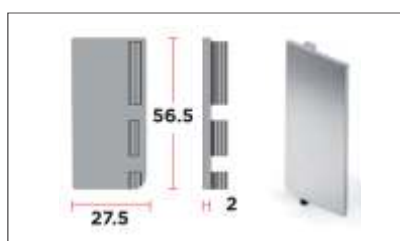

CODE NO.	FINISH
CF8006TP50SC-L	Matt
CF8006TP50SC-L	Chrome LU5

CLOSE MODEL CLOSING CAP



CODE NO.	FINISH
CF8006TP50SC-R	Matt
CF8006TPLU5C-R	Chrome LU5

OPEN MODEL CLOSING CAP

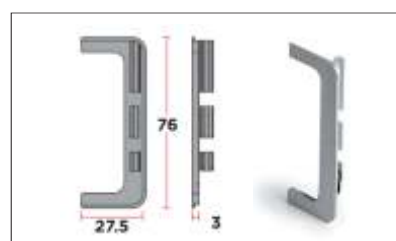

CODE NO.	FINISH
CF8007TP50S-L	Matt
CF8007TPLU5-L	Chrome LU5

OPEN MODEL CLOSING CAP

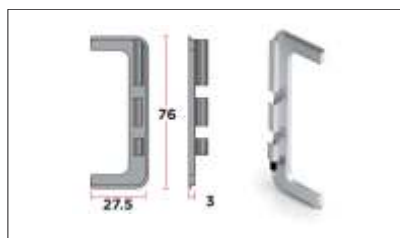

CODE NO.	FINISH
CF8007TP50S-R	Matt
CF8007TPLU5-R	Chrome LU5

CLOSE MODEL CLOSING CAP

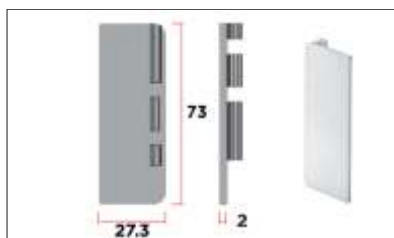

CODE NO.	FINISH
CF8007TPI50SC-L	Matt
CF8007TPILU5C-L	Chrome LU5

CLOSE MODEL CLOSING CAP

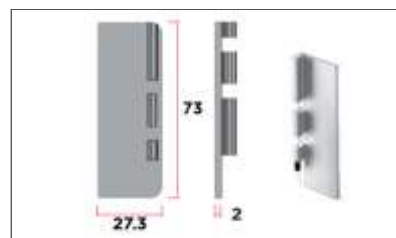

CODE NO.	FINISH
CF8007TPI50SC-R	Matt
CF8007TPILU5C-R	Chrome LU5

EASY LINE



CODE NO.	DESCRIPTION	DIMENSION
KSAL1054	PVC Slat and Aluminium track	600 X 1350

METALLIC LINE



CODE NO.	DIMENSION	DESCRIPTION
KSALR1051	600 X 1000	Aluminium slat and Aluminium track
KSALR1052	600 X 1500	
KSALR1053	900 X 1500	
KSALR1066	600 X 1000	Stainless steel slat and Stainless steel track
KSALR1067	600 X 1500	
KSALR1068	900 X 1500	

HANDLES (EUROPEAN)

EVISA



CODE NO.	FINISH	DIMENSION
HLHS3177	Bright Chrome	128mm

EVISA



CODE NO.	FINISH	DIMENSION
HLHS3178	SS Look	128mm

BALDONE



CODE NO.	FINISH	DIMENSION
HLHS3181	Bright Chrome	160mm

BALDONE



CODE NO.	FINISH	DIMENSION
HLHS3182	SS Look	160mm

DINIA



CODE NO.	FINISH	DIMENSION
HLHS3186	Bright Chrome	128mm

DINIA



CODE NO.	FINISH	DIMENSION
HLHS3187	Matte Nickel	128mm

INTRA



CODE NO.	FINISH	DIMENSION
HLHS3192	Bright Chrome	192mm

HANDLES (SS 304)

SP017



CODE NO.	FINISH	DIMENSION
HLHA3238	Matt	128mm
HLHA3229	Matt	160mm

SP018



CODE NO.	FINISH	DIMENSION
HLHA3239	Combi	128mm
HLHA3230	Combi	160mm

SP028



CODE NO.	FINISH	DIMENSION
HLHA3240	Matt	128mm
HLHA3231	Matt	160mm

SP031



CODE NO.	FINISH	DIMENSION
HLHA3211	Matt	128mm
HLHA3210	Matt	160mm

SP033



CODE NO.	FINISH	DIMENSION
HLHA3241	Matt	128mm
HLHA3232	Matt	160mm

SP034



CODE NO.	FINISH	DIMENSION
HLHA3213	Matt	128mm
HLHA3233	Matt	160mm

SP046



CODE NO.	FINISH	DIMENSION
HLHA3242	Matt	128mm
HLHA3234	Matt	160mm

SP066



CODE NO.	FINISH	DIMENSION
HLHA3243	Matt	128mm
HLHA3235	Matt	160mm

SP067



CODE NO.	FINISH	DIMENSION
HLHA3244	Matt	128mm
HLHA3236	Matt	160mm

SP068



CODE NO.	FINISH	DIMENSION
HLHA3245	Matt	128mm
HLHA3215	Matt	160mm



SLEEK INTERNATIONAL PVT. LTD.
Call: 1800 21 20 200 | www.sleekworld.com

© Copyrights reserved. Sleek International Pvt. Ltd. 08/2016

"All the information and contents on the booklet/Web Site/brochure/catalogue are owned and exclusive property of Sleek International Pvt. Ltd. and protected under the Copyrights Act, 1957 and the Copyright Laws of all other countries worldwide under the Berne Convention. All rights are reserved and no part of this booklet/Web Site/brochure/catalogue shall be reproduced, stored in a retrieval system or transmitted in any form or by any means - electronic, electrostatic, magnetic tape, mechanical, printing, photocopying, recording or otherwise including the right of translating in any language without the prior written consent of Sleek International Pvt. Ltd."

