

PRODUCT CODE AD01A001

Loctite Quick

Asian Paints Loctite Quick is a high viscosity instant adhesive which secures together a wide range of materials within seconds to give high bond strength. Its ultra high viscosity lends it a controlled flow, making it a no-spill, no-mess adhesive. It can efficiently be applied to vertical surfaces, in a contour and in gaps.



PRODUCT BENEFITS

NO MESS

Controlled viscosity makes it easier to use with no mess, no wastage

APPLICATION EASE

Can be easily applied in a contour and does not get absorbed in porous substrates

VERTICAL APPLICATION

Does not drip, hence suitable for vertical surfaces and precision applications

REPOSITIONING TIME

Gives 5-10 seconds open time to reposition joining surfaces

RE-USABILITY

Has a longer shelf life and can easily be stored and re-used

LEAD FREE* GUARANTEE



* All Asian Paints products contain no added Lead, Mercury, Arsenic or Chromium from April 2008.

PRODUCT FEATURES

AVAILABLE PACKS

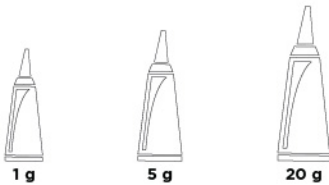

PRODUCT APPEARANCE

CLEAR

SETTING TIME



10-15 SECONDS

RECOMMENDED USAGE



METAL



STONE



WOOD



GLASS



PLASTICS



RUBBER

HOW TO APPLY

PRE-APPLICATION STEPS

ROUGHEN, DRY AND CLEAN SURFACES TO BE BONDED



Clean and dry surfaces to be bonded.

APPLICATION PROCESS

STEP 1



Screw the nozzle clockwise to pierce the metal seal.

STEP 2



Apply adhesive to one surface only.

STEP 3



Hold both surfaces together until set.

STEP 4

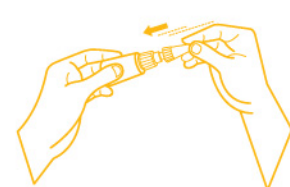

After use, replace cap. Store in a cool, dry place.

ADDITIONAL INFORMATION

SAFETY FEATURES

- Store the container with the lid tightly closed in a cool, dry place
- Keep out of reach of children and away from eatables.
- May be harmful if swallowed. In case of ingestion seek immediate medical attention.
- Wear eye protection during application. In case of contact with eyes, rinse with plenty of water and seek medical advice immediately
- In case of skin contact immediately wash skin with warm water. Get medical attention if irritation develops.
- Do not breathe vapour. It is recommended to wear suitable nose pad during sanding and surface preparation to avoid dust inhalation
- Do not pour leftover adhesive down the drain or in water courses.

TECHNICAL DETAILS

- Open time: 10 seconds
- Shelf Life: 12 months from date of manufacture
- Storage Temperature: 12-25 degree C

PRECAUTIONS

- Avoid using more than the prescribed quantity of adhesive, as a thick layer between the bonding surfaces may affect the bond strength
- Do not apply with your fingers